

970

# Inline Regulator

10 - 25 PSI / 0.7 - 1.7 Bar

3/4" MNPT Inlet / Outlet

## Assembly Instructions

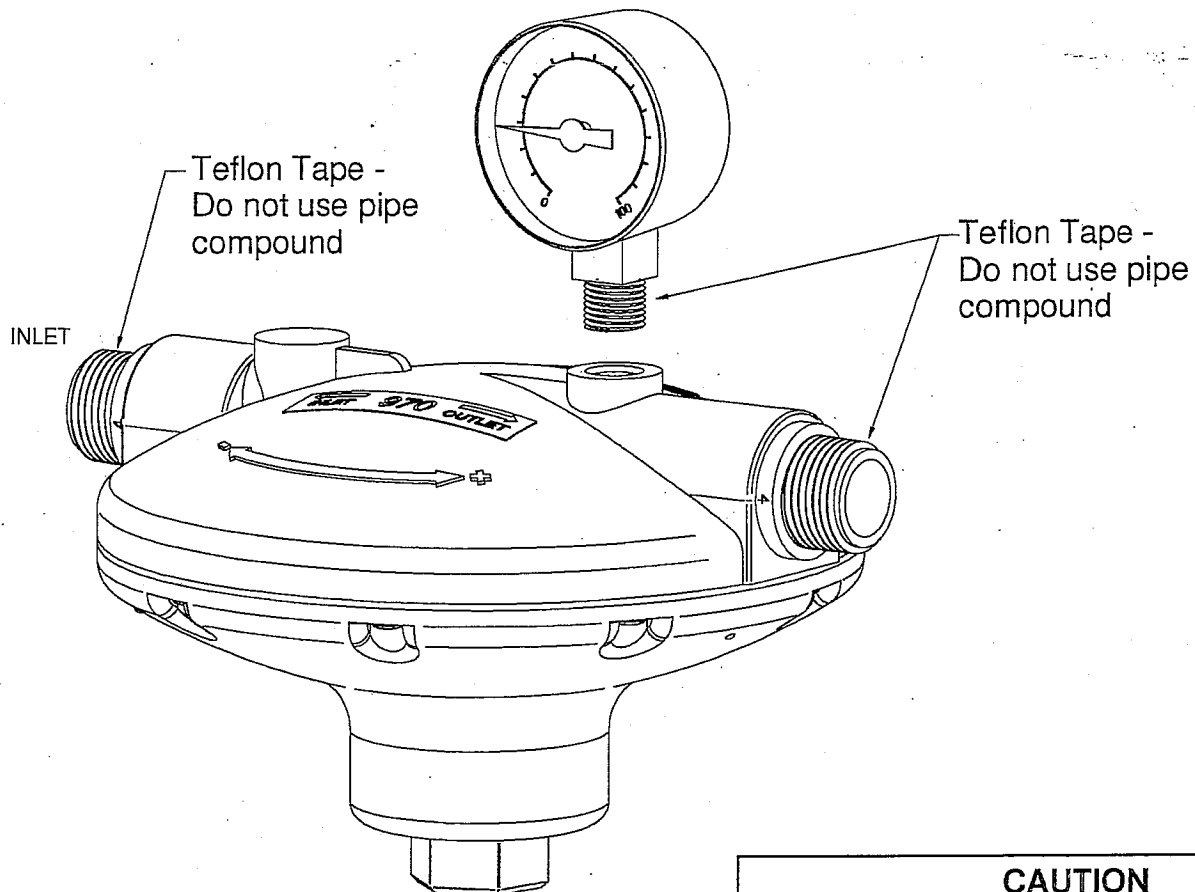
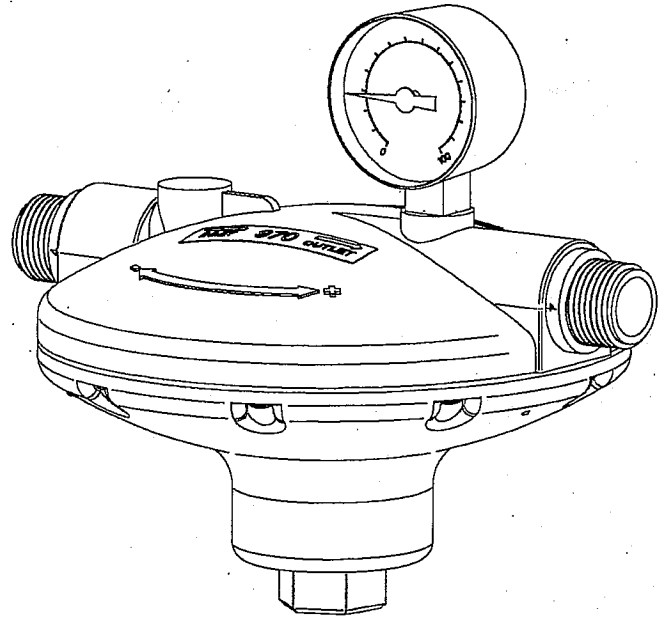

### CAUTION

- MAXIMUM REGULATOR INLET PRESSURE NOT TO EXCEED 40 PSI/2.72 BARS.
- DO NOT ALLOW THIS ITEM TO COME INTO CONTACT WITH PETROLEUM, PHENOL OR ALDEHYDE BASED PRODUCTS OR ANY OTHER CORROSIVE PRODUCT IN GENERAL.

# COMPONENTS

PART NR.	QTY	DESCRIPTION
180	1	PRESSURE GAUGE: 0 - 100 PSI / 7 BAR
83	11	FASTENER: SCREW PAN HD PHILLIPS #7 - 18 X 1/2" LG - PLASTITE THREAD
187	1	REGULATOR PART: ADJUSTMENT HOUSING - STANDARD & INLINE
449	1	REGULATOR PART: SPRING 10 - 25 PSI
975	2	REGULATOR PART: RETAINER BLOCK - INLINE
978	1	REGULATOR PART: ANTI-FRICTION RING - INLINE
983	1	REGULATOR PART: INLET/OUTLET HOUSING - INLINE 3/4" MNPT
89	1	FASTENER: NUT HEX 5/16"-18 X 1/2" WD X 17/64" H
974	1	REGULATOR PART: SHOULDER BOLT - MINI & INLINE
976	1	REGULATOR PART: DIAPHRAGM BACKING PLATE - INLINE
977	1	REGULATOR PART: DIAPHRAGM 5 - 25 PSI - INLINE
1016	1	REGULATOR PART: ADJUSTMENT KNOB ASSEMBLY - INLINE
1017	1	REGULATOR PART: PRESSURE REDUCER RING - INLINE
88-V	1	REGULATOR PART: OPENING ARM SEAT
973	1	REGULATOR PART: OPENING ARM - INLINE W/O SEAT

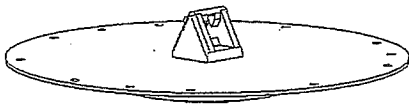
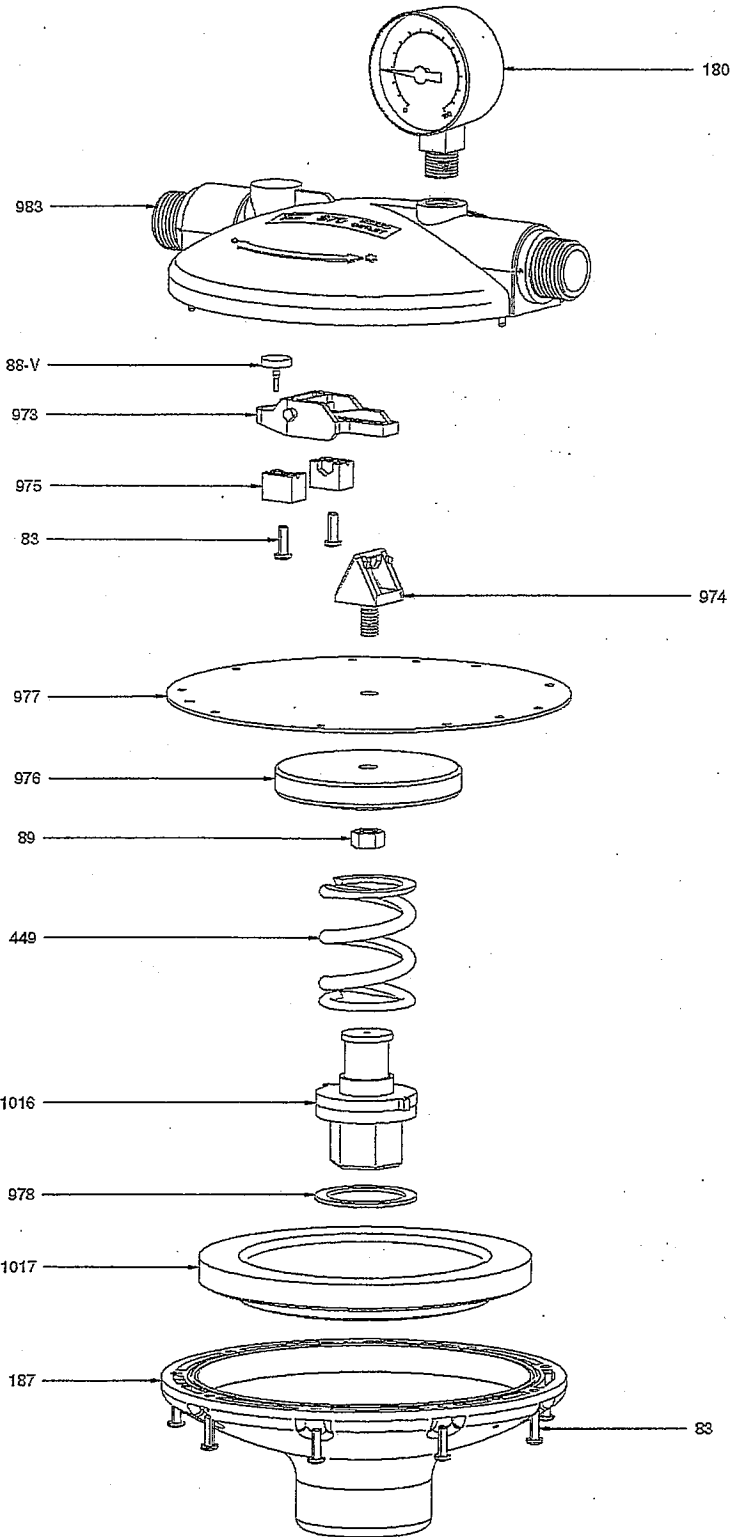

984 ASSEMBLY

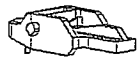

1198 ASSEMBLY