

# Incredibly Durable.

## HyperMAX™ Fiberglass Belt Drive Fans 36", 48" or 50"

### High Performance - Maximum Value

VAL-CO's tested and proven designs deliver superior performance and value.

### Superior Design of the Motor and Motor Mount

- The HyperMAX motor mount and drive assembly utilizes a rugged box frame design to improve performance, efficiency, increase motor life and provide quiet operation.
- An auto belt tensioner reduces maintenance.
- Standard with auto tensioner or reverse drive is available.
- Energy efficient, waterproof motors with sealed ball bearings and thermal overload protection are manufactured to VAL-CO's exacting specifications.
- Motor options include single or three phase motors in 50 Hz or 60 Hz and various operating voltages.
- Unique four-point, galvanized or stainless steel motor mount design provides minimum air restriction and vibration-free performance.

### Engineered Blade Design

- Computer design orifice-blade-cone-motor combination assures optimum use of the motor power curve while reducing starting and running amps.
- Blade options include rust proof stainless steel, cast aluminum or galvanized.
- Matching blades and energy-efficient motors provide maximum CFM/watt of electrical power.

### Durable Construction

- Corrosion-resistant, high quality housing construction of molded fiberglass providing superior durability and long life.
- Performance enhancing exhaust cones are available in fiberglass or poly.
- Slant wall design provides reduced weather intrusion, easy cleaning, water drainage and improved performance.
- Full 1" diameter drive shaft, with rust proof coating, is square keyed for non-slip operation.
- Pre-lubricated industrial grade pillow block bearings are self-aligning, low maintenance and add longer life.
- High quality shutters are available in aluminum or black or white PVC.
- Tough rust proof shutter clips are designed with stay-put features.
- Stainless steel self-locking fasteners are corrosion resistant.
- Energy doors are available.

**HyperMAX Fans  
are backed by  
VAL-CO's  
long-life warranty -  
see dealer for details.**



Motor mount and drive assembly utilize a rugged box frame design to increase motor life.

# Dimensions for HyperMAX™ Fiberglass Fans

Our ventilation experts can also assist with retrofitting an existing or designing a new facility for maximum efficiency.

	36"	48"	50"
"A"	48.5"	59.5"	62.25"
"B"	7"	8.5"	8.5"
"C" Long Cone	50.25"	64.5"	64.5"
"C" Short Cone	N/A	N/A	59"
"D" Long Cone	47"	48"	49.25"
"D" Short Cone	N/A	N/A	39.25"

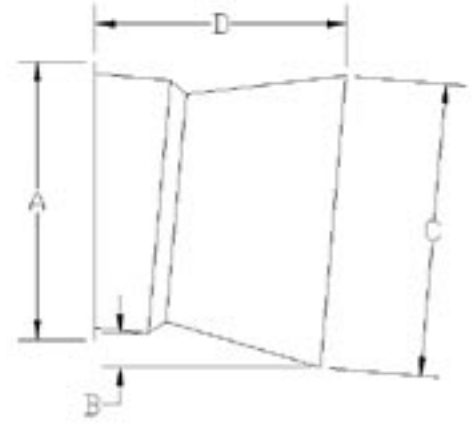

## 36" Models

## CFM vs. Static Pressure (Inches WG)

Model	Blade	HP	Voltage	Amps	RPM	0		0.05		0.1		0.15		BESS #
						CFM	Cfm/Watt	CFM	Cfm/Watt	CFM	Cfm/Watt	CFM	Cfm/Watt	
HPM36W280MGA	Steel	1/2	230	2.6	840	13600	24.4	12600	21.2	11700	18.6	10700	15.9	06048
HPM36^280M*A	Alum	1/2	230	2.3	834	11520	23.1	10670	20.6	9840	18.6	8950	16.4	01296
HPM36W290MGA	Steel	1/2	115/230	2.9	677	13300	23.2	12200	19.6	11000	16.4	9600	13.7	06046
HPM36W290MNA	Alum	1/2	115/230	2.5	848	11500	22.8	10500	19.5	9500	17.1	8600	14.8	06047
HPM36W340LGA	Steel	1	115/230	4.6	838	15900	18.2	15100	16.4	14300	14.7	13400	13.1	06045

## 48" Models

Model	Blade	HP	Voltage	Amps	RPM	0		0.05		0.1		0.15		BESS #
						CFM	Cfm/Watt	CFM	Cfm/Watt	CFM	Cfm/Watt	CFM	Cfm/Watt	
HPM48W340MSA	Steel	1	115/230	5.7	599	25700	23.5	24300	20.8	23300	18.8	21900	16.8	06030
HPM48W340MNA	Alum	1	115/230	2.2	572	26200	24	24700	21.6	23300	19.7	21700	17.6	05134
HPM48W420LSA	Steel	1-1/2	115/230	2.5	635	27300	19.7	26200	17.9	24900	16.3	23700	14.8	06036
HPM48^420L*A	Alum	1-1/2	115/230	7.1	603	25817	21.1	24464	19.2	23062	17.7	21302	15.9	02457
HPM48W600MSA	Steel	1	230/460	1.9	563	25000	24.7	23700	22	22300	19.5	20700	17.3	06035
HPM48W600MNA	Alum	1	230/460	3.2	568	25400	25.2	23900	22.6	22200	20	20600	18	05135
HPM48W610MSA	Steel	1	200/400 (50Hz)	1.7	583	24000	26.2	22500	23	20900	20.2	19200	17.7	06034
HPM48W650LSA	Steel	1-1/2	230/460	4.3	638	26000	22.7	24900	20.4	23500	18.2	22200	16.4	06032
HPM48W650LNA	Alum	1-1/2	230/460	4.6	632	26300	19.6	25100	18.3	23900	17	22600	15.6	06031
HPM48W730LSA	Steel	1-1/2	380 (50Hz)	2.2	644	26300	22.9	25100	20.6	23700	18.3	22300	16.5	06033
HPM48W340MDA	6 Blade Steel	1	115/230	5.6	477	24900	22.7	23700	20.6	22500	18.6	21000	16.6	06029

## 50" Models

Model	Blade	HP	Voltage	Amps	RPM	0		0.05		0.1		0.15		BESS #
						CFM	Cfm/Watt	CFM	Cfm/Watt	CFM	Cfm/Watt	CFM	Cfm/Watt	
HPM50W340MSA	Steel	1	115/230	5.7	599	26900	24.1	25600	21.6	24100	19.4	22600	17.3	06050
HPM50^340N*A	Steel	1	115/230	3.8	510	24445	30.6	22757	26.6	20898	23	18854	19.7	02031
HPM50^340M*A	Alum	1	115/230	5.5	540	26922	25.1	25425	22.8	23773	20.4	21832	18.1	02228
HPM50^340M*A <sup>3</sup>	Alum	1	115/230	5.6	540	25735	23.2	24159	20.9	22630	19.1	20852	17.1	02229
HPM50^340N*A	Alum	1	115/230	4.7	505	25108	28.5	23404	25.3	21563	22.4	19364	19.4	02235
HPM50W730LNA	Alum	1-1/2	380 (50Hz)	2.2	572	27600	22.5	26100	20.4	24600	18.6	22900	16.8	06026
HPM50W730LSA	Steel	1-1/2	380 (50Hz)	2.5	635	28200	20.5	26900	18.8	25600	16.8	24100	15.3	06027
HPM50W610MSA	Steel	1	230/460	1.9	563	25300	23.2	23700	20.7	22000	18.4	20100	16.1	06028
HPM50^420L*A	Steel	1-1/2	115/230	7.8	628	29746	21.1	28229	19.5	27153	17.7	25618	16	02040
HPM50^420L*A	Alum	1-1/2	115/230	7.7	583	29016	20.8	27733	19.1	26223	17.5	24531	15.9	02232
HPM50^600M*A	Steel	1	200-230/460	3.1	555	26680	26.6	25150	23.6	23398	20.9	21535	18.4	02036
HPM50^600N*A	Steel	1	200-230/460	2.5	497	23991	32.2	22492	28.1	20298	23.8	18111	20.2	02037
HPM50^600M*A	Alum	1	200-230/460	3.1	521	26022	26.2	24412	23.4	22623	20.9	20540	18.4	02242
HPM50^600M*A <sup>2</sup>	Alum	1	200-230/460	3.2	521	24644	23.7	22803	21.3	21003	19.0	18689	16.5	02240
HPM50^650L*A	Steel	1-1/2	200-230/460	4.8	624	29698	21.6	28430	19.6	26943	17.8	25451	16.2	02039
HPM50^650L*A	Alum	1-1/2	200-230/460	4.6	577	28823	21.4	27353	19.6	25853	18.1	23722	16.4	02244

### NOTES:

- Each @ .05 Static Pressure and 230Volts/60Hz
- Bess Labs Website is [www.bess.uiuc.edu](http://www.bess.uiuc.edu)
- Fan tested with a short cone

<sup>^</sup> - Housing Color (W = White, B = Black)

<sup>\*</sup> - Blade / Motor Mount Material Combo

G = Galvanized Blade & Motor Mount

S = Stainless Steel Blade & Motor Mount

C = Cast Aluminum Blade & Stainless Steel Motor Mount

N = Cast Aluminum Blade & Galvanized Motor Mount

P = Composite Blade & Stainless Steel Motor Mount

Call your local VAL-CO representative or distributor for more information on these and our other fine products.

North America:

Phone: 800.99VALCO (800.998.2526)

Fax: 419.678.2200

E-mail: [sales@valcompanies.com](mailto:sales@valcompanies.com)

International:

Phone: 717.392.3978

Fax: 717.735.1800

E-mail: [intl.sales@valcompanies.com](mailto:intl.sales@valcompanies.com)

